

ADVANCED HIGH CEILING

DOT - Accessory and optics installation



**IMPORTANT SAFETY INFORMATION.
READ AND FOLLOW ALL SAFETY INSTRUCTIONS**

IMPORTANT SAFETY INFORMATION. READ AND FOLLOW ALL SAFETY INSTRUCTIONS. Before wiring to power supply and during servicing or relamping, turn off power at fuse or circuit breaker. All servicing or relamping must be performed by qualified service personnel. Product must be grounded to avoid potential electric shock or other potential hazard. Product must be at locations and at heights and in a manner consistent with its intended use, and in compliance with Electrical Code and local codes.

SAVE THESE INSTRUCTIONS FOR FUTURE REFERENCE.

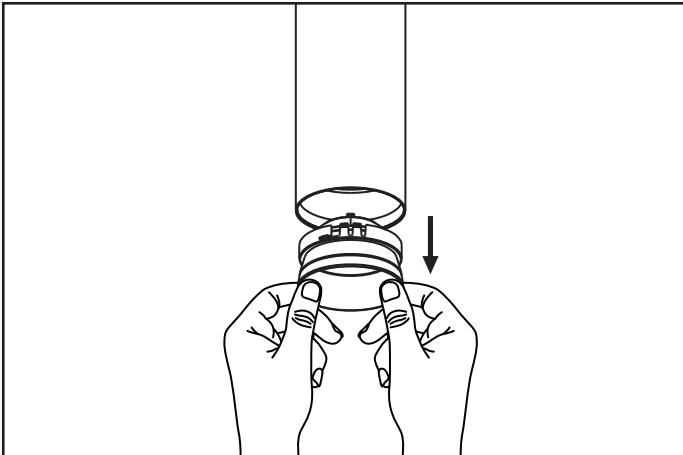

Step 1

Simply tug on the trim to remove the optics.

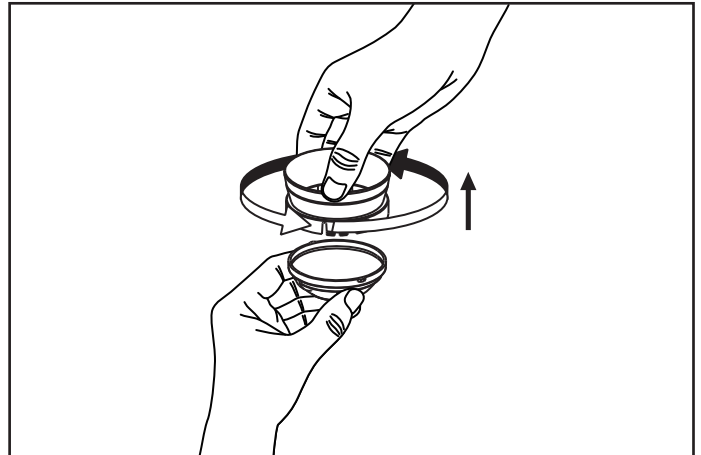

Step 2

Turn the trim clockwise to unlock the lens holder.

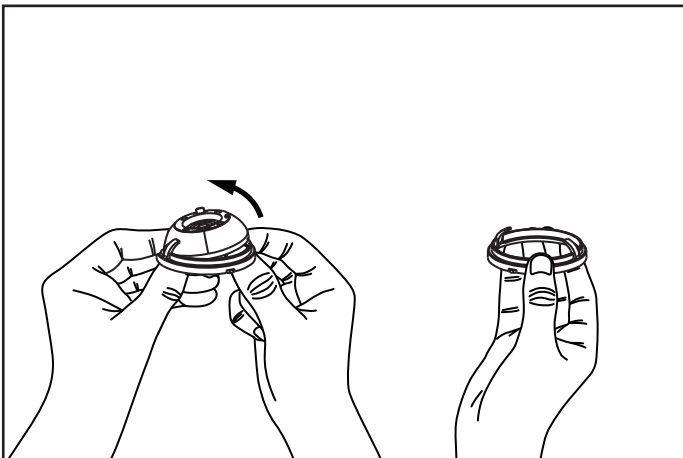

Step 3

Facing down, push up on the optics from underneath until it slides out.

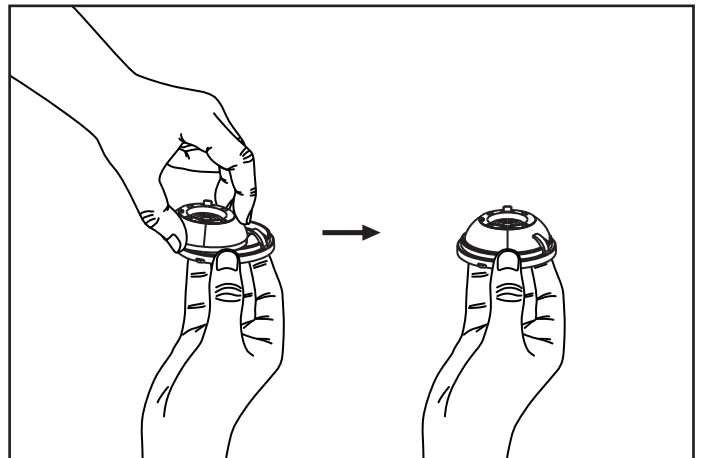

Step 4

Replace with desired optics and slide into place.

ADVANCED HIGH CEILING DOT - Accessory and optics installation

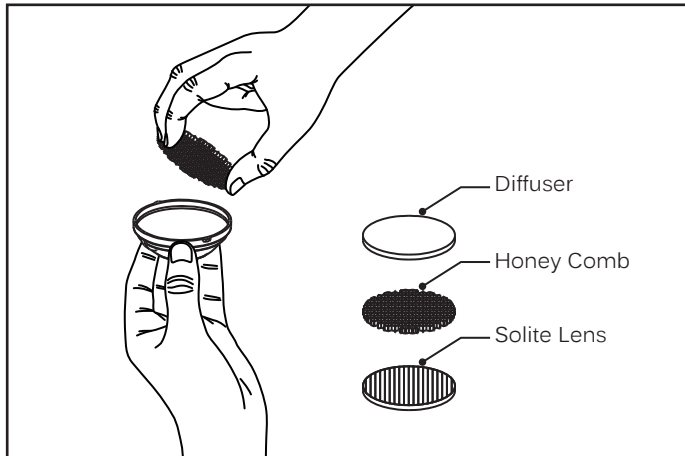

Step 5

When adding an accessory, add it on top of the optics as indicated.

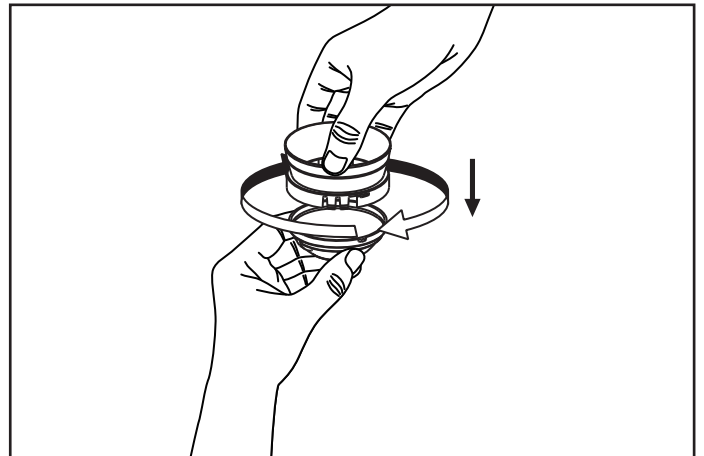

Step 6

Turn the trim anti-clockwise to clasp the lens holder.

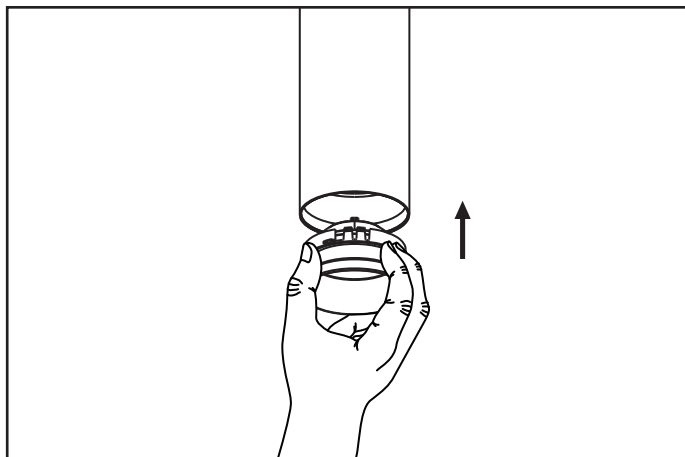

Step 7

Push back the trim and optics back into the fixture.